



# FOR LEASE

1805 Carnegie Ave.  
Santa Ana, CA 92705

2,900 SF Industrial Unit

## SITE HIGHLIGHTS:

- Business Park Environment
- Professional Property Management
- Excellent Access to the 55, 405, and 5 Freeways
- Adjacent to The District at Tustin Legacy
- Zoning: M1 - Light Industrial

## UNIT FEATURES:

- Reception + 2 Private Offices
- Kitchenette
- Two Restrooms
- 10' x 12' Ground Level Warehouse Door
- 14' Warehouse Clearance



## FOR FURTHER DETAILS:

**PARKER ROBERTS**

parker@tricoREALTY.com  
License #01994597

This information has been furnished from sources which we deem reliable; however, we do not guarantee its accuracy and assume no liability. Do not rely on any of the information contained herein without verifying it yourself directly with the listing broker or owner.

**Trico Realty, Inc.**  
License #00342120

3100-A Pullman Street  
Costa Mesa, CA 92626

**714-751-4420**  
TricoRealty.com



# FOR LEASE

1805 Carnegie Ave.  
Santa Ana, CA 92705

2,900 SF Industrial Unit

## Unit Features

 Power: 100A | 120/240

 Clearance Height: 14'

 Ground Level Doors: One 10'x12'

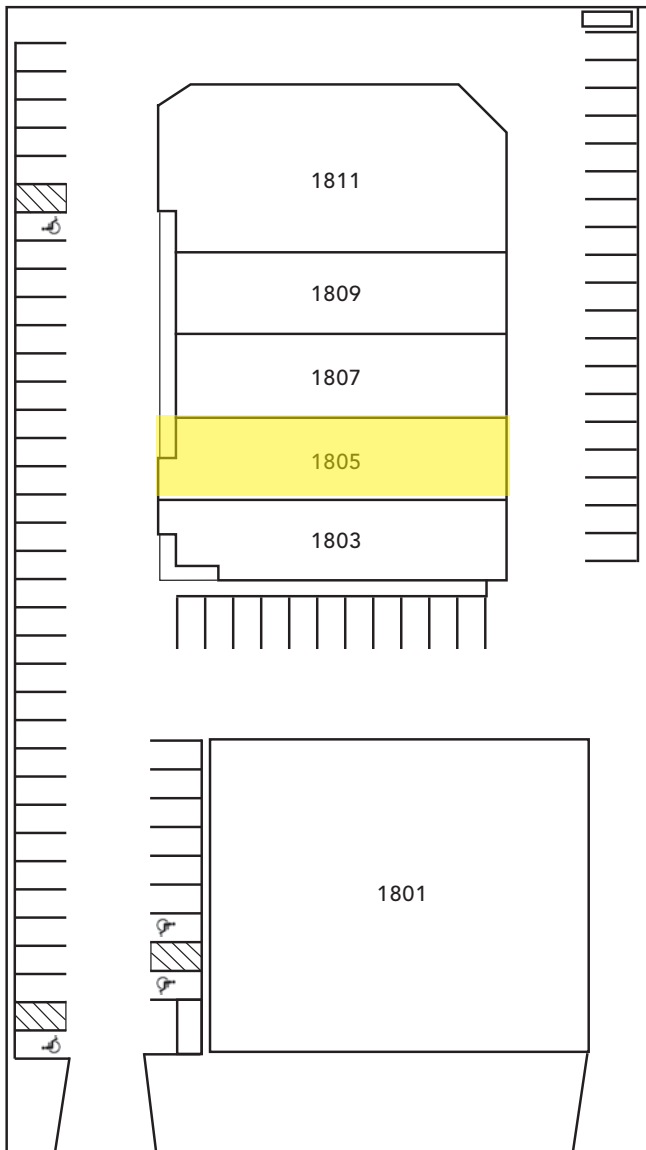

Carnegie Avenue

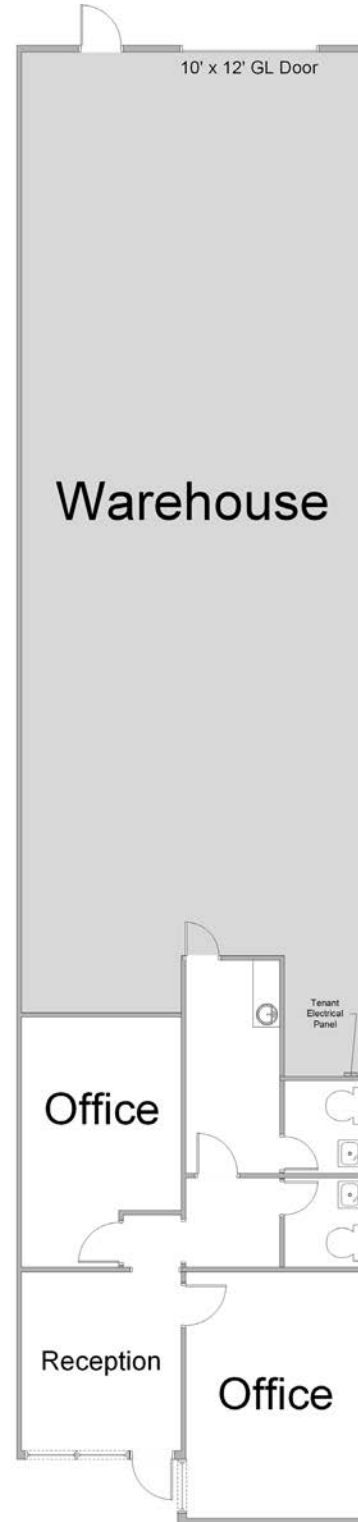

\*Floorplans Not to Scale

**PARKER ROBERTS**  
parker@tricoREALTY.com  
License #01994597

714-751-4420  
TricoREALTY.com  
License #00342120